

# PRESSURE RELIEF VALVE -SERIES 500

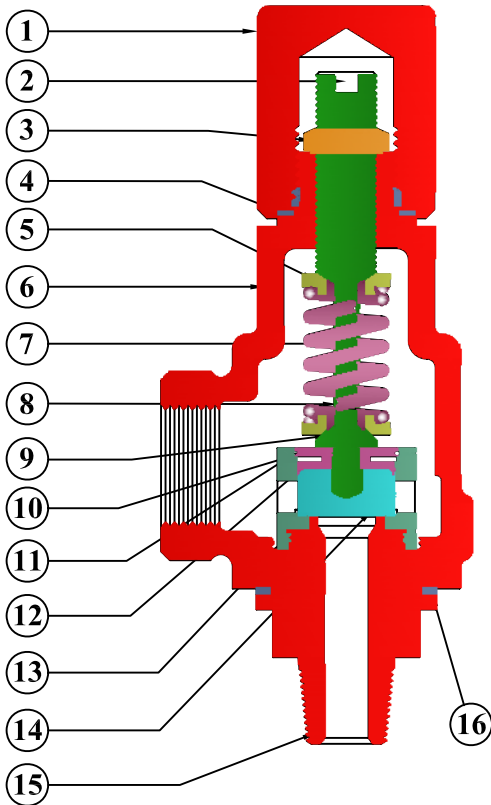

## TECHNICAL SPECIFICATION

- Built in conformance to ASME code section/API for air, stem, and Liquid Service.
- Valve Size:-  $\frac{1}{2}$ " x 3"
- Set Pressure to 2500 PSIG.
- Stainless Steel body and trim.
- Carbon steel bonnet and cap.
- Flat seats for easy maintenance.

## Dimensions & Weights

Type	A		B	C
	Plain Cap	Packed Lever		
MM	170	203	43	67

INDEX	PART NAME	MATERIAL
1	CAP	C.S/304/316/BRASS
2	ADJ.SCREWED	S.S 304/316/BRASS
3	NUT	S.S 304/316/BRASS
4	CAP GASKET	P.T.F.E
5	SPRING BUTTON	C.S/304/316/BRASS
6	BODY	C.S/304/316/BRASS
7	STEM	S.S304/316/BRASS
8	SPRING	SPRING STEEL/S.S.302
9	STEM SHOULDER	S.S304/316/BRASS
10	LIFT STOP RING	S.S.304/316
11	SPRING LOCK	SPRING STEEL/S.S.302
12	LOCK WASHER	S.S.304/316
13	RECTION HOOD	S.S 304/316/316L
14	DISC	S.S 304/316/316L(TEFLONE INSERT)
15	NOZEL	S.S 304/316/316L
16	BODY GASKET	S.S 304/316

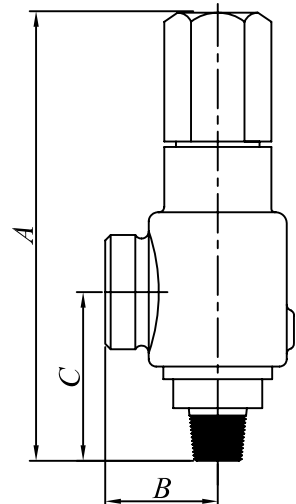

## Nutech Valves

37, Shreeji Industrial Estate, Raypur Mill Compound, Saraspur, Ahmedabad - 24

Ph..( O ) :- 079 - 29292112, 32923375 Fax :- 079 - 22133122

E-Mail :- sales@nutechvalves.com Website :- www.nutechvalves.com

**AN ISO 9001:2000 Certified Co.**